

04 – Modifier keys (Alt)

Modifier keys (Alt)

Ribbon access

Alt activates the Ribbon

- Follow key tip (letters in black boxes) sequence (e.g. **Alt, H, F, C**)

The diagram illustrates the sequence of Alt key presses to access the Font ribbon in Microsoft Excel. The sequence is Alt, H, F, C.

1. Pressing **Alt** highlights the ribbon tabs (File, Home, Insert, Page Layout, Formulas, Data, Review, View).

2. Pressing **H** highlights the Home ribbon.

3. Pressing **F** highlights the Font group.

4. Pressing **C** activates the Font color dropdown menu.

The right side of the image shows the Font color dropdown menu open, displaying Theme Colors and Standard Colors.

Modifier keys (Alt)

Accelerator keys

Alt+Letter Key for underlined letter will execute the associated command

- Open Format Cells Dialog Box [Alt, H, F, N] or Ctrl+1

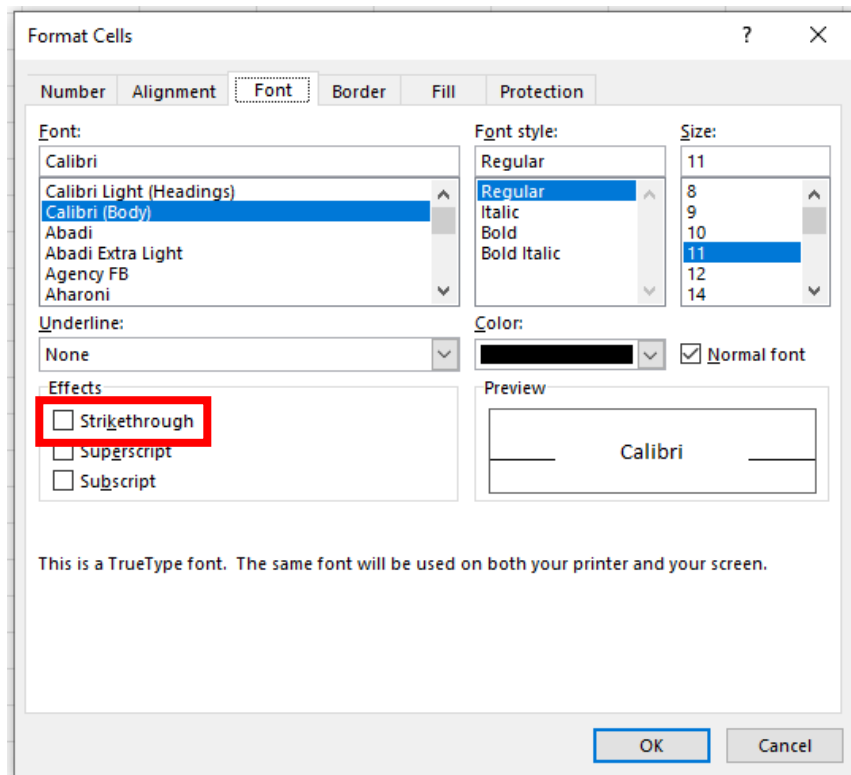

Alt+K (1)

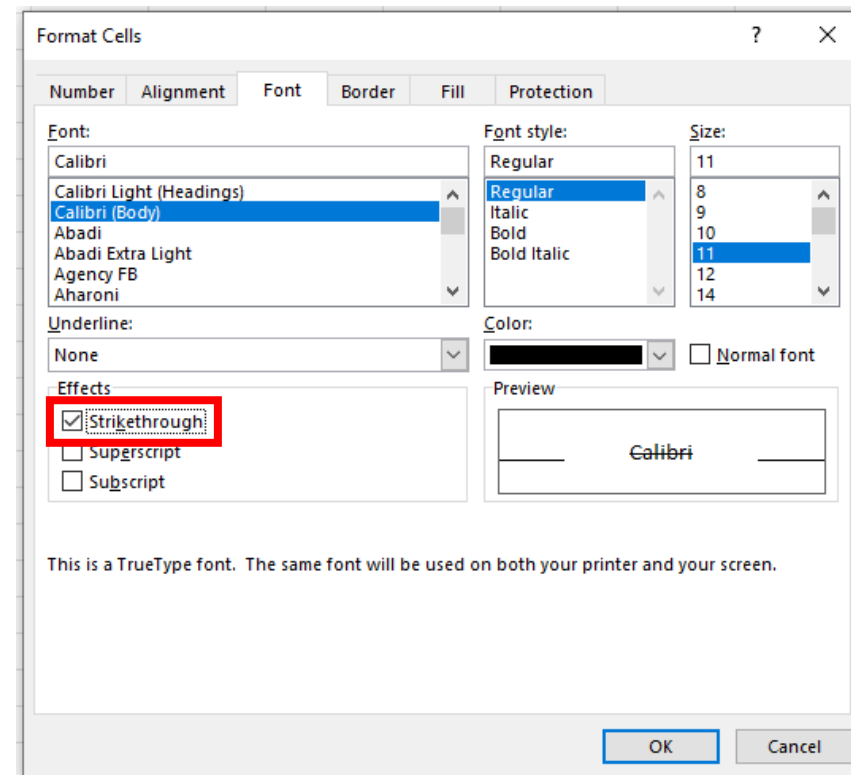

(1) Underlined letter only may also work (but this depends on control focus).